

2,109 sqft



3 bedroom+  
1 office



2 bathroom



3 car garage



## FEATURES:

- SPA-LIKE MASTER BATHROOM
- OPEN CONCEPT FLOOR PLAN
- LARGE LAUNDRY ROOM
- LARGE COVERED PATIO



**COLDWELL BANKER**  
**TOMLINSON**

**VP** ———  
VP TEAM

509.221.0546



2,109 sqft

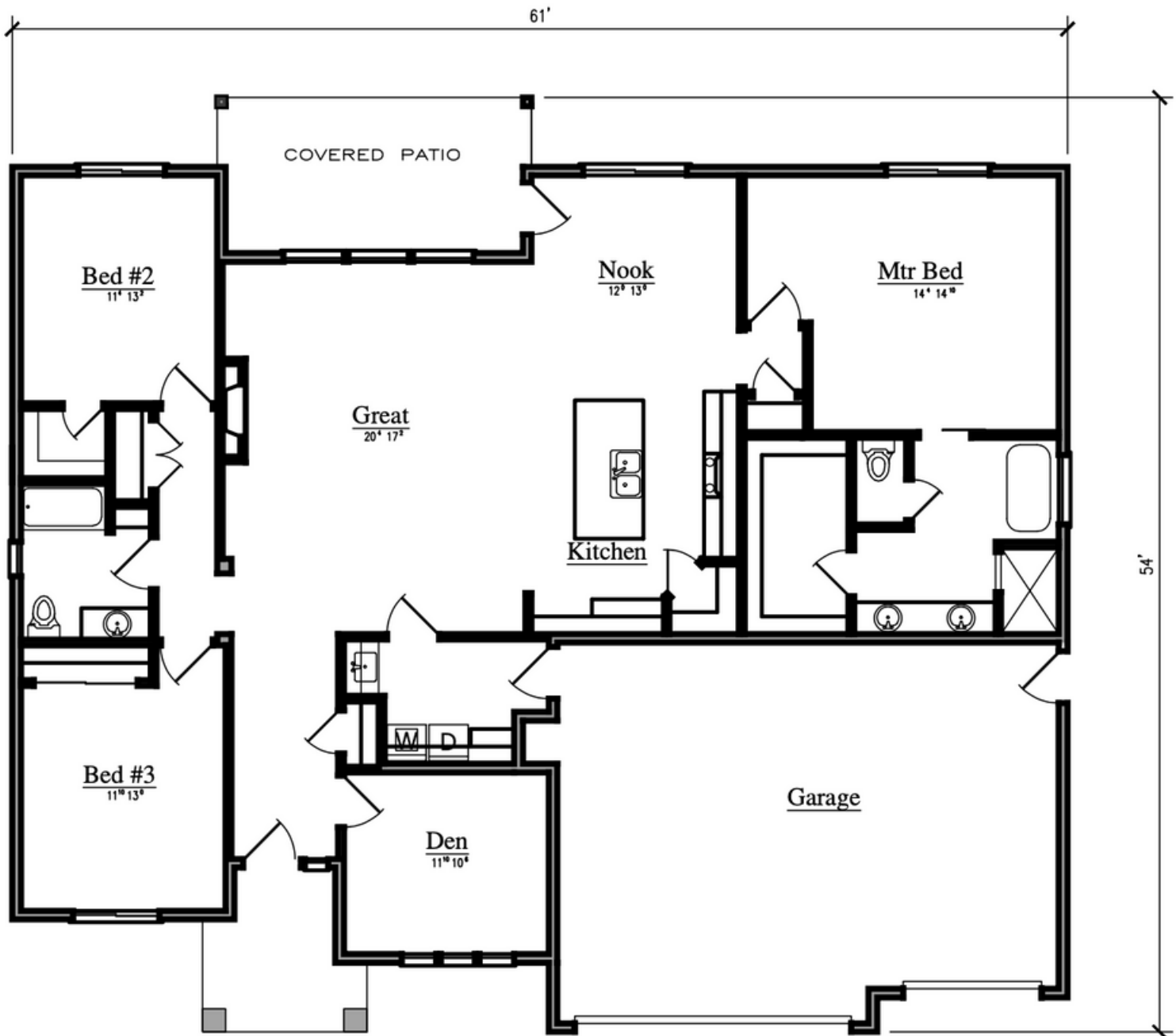

Main Floor Plan

SIGNATURE HOMES LLC RESERVES THE RIGHT TO MODIFY FLOOR PLANS, DESIGNS AND PRICES. DIMENSIONS AND SQUARE FOOTAGE ARE APPROXIMATE